



All contents of this presentation are copyright Geothermal International Limited. Reproduction is forbidden without specific permission of Geothermal International Limited.

Lee Marshall

CEng MCIBSE

Engineering Manager

geothermal international

lm@geothermalint.co.uk

© Geothermal International



- Established in 2000
- Provide a complete service to the ground sourced heat pump market
- Over 90 MW of installed capacity
- Systems from 6 kW to 10MW
- Pan European



Applications

Geothermal has been successfully applied to:

- Offices
- Hotels
- Individual Homes
- Apartment Buildings
- Supermarkets
- Residential Developments
- Schools
- Hospitals
- Manufacturing
- Sports Centers
- Agriculture
- Government Buildings
- Stately Homes



© Geothermal International

Low Operating & Maintenance Costs

- Significant Fuel Cost Savings
- 3 to 6 Year Typical Payback on Additional Investment
- High Inherent Reliability
- Low Cost Planned Maintenance Available
- 20+ Year Typical Unit Life
- 200+ Year Ground Loop Life
- Greater COP's



How The Units Work

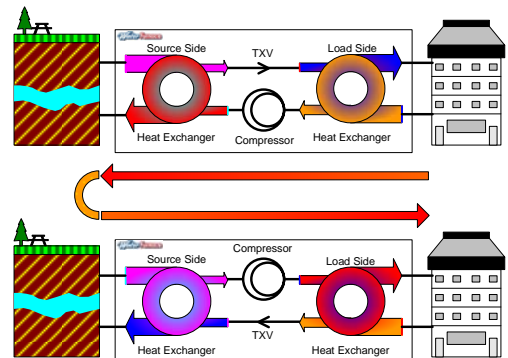

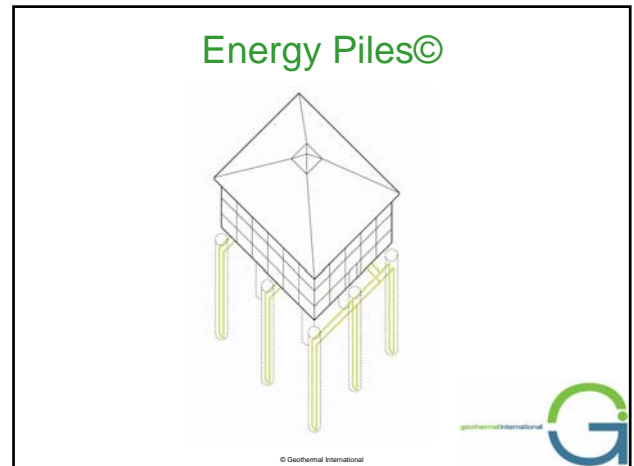
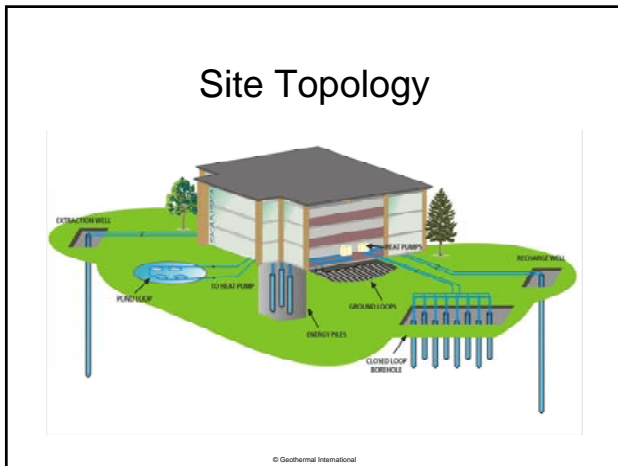
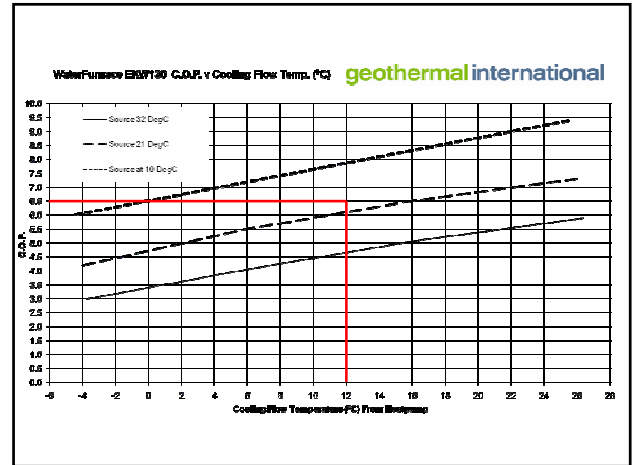
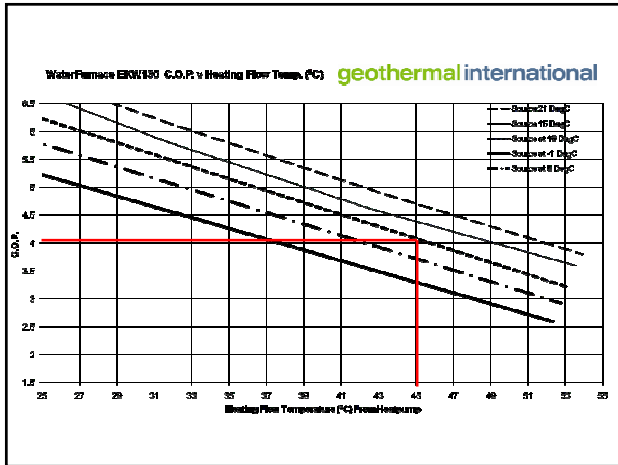

Paddington Building 3, London

- System:
 - Energy Piles©
- Size:
 - 210kW Heating
 - 85kW Cooling
- Collector type:
 - 54 Piles
 - Depth 25m
- Completed:
 - 2006

A photograph showing the construction site for the Paddington Building 3 in London. The image shows a large concrete structure under construction with a crane in the background.

© Geothermal International





Energy Piles© & Closed Loop



© Geothermal International



Embassy Court

- System:
 - Energy Piles & Bores
 - Dry Cooler
- Size:
 - 202kW Heating
 - 371kW Cooling
- Collector type:
 - 100 Piles + Bores
 - Depth 40m
- Completed
 - 2008

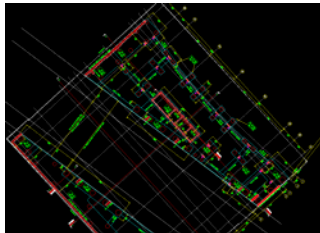

© Geothermal International



North Kent Police PFI

- System:
 - Energy Piles, Closed Loop & Dry Cooler
- Size:
 - 550kW Heating
 - 1,350kW Cooling
- Collector type:
 - 250 Piles to 23m
 - 80 Bores to 100m
- Completed:
 - 2008



© Geothermal International



Energy Piles© & Open Loop

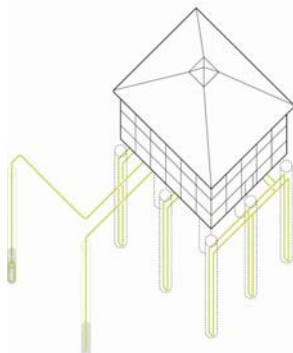

© Geothermal International



One New Change, London

- System:
 - Piles & Open Loop
- Size:
 - 1,638kW Heating
 - 1,742kW Cooling
- Collector type:
 - 219 Energy Piles
 - Open Loop Wells
- On Site:
 - 2007



© Geothermal International



Ground Loop Installation

Pipe Loops & Ancillary Components





Bore Field Drilling



The 'Bore Field Drilling' slide contains three small photographs. The top-left photo shows a drilling rig with a worker. The top-right photo shows a drilling rig with a worker. The bottom photo shows a large construction site with a drilling rig. The logo 'G' is visible in the bottom right corner.

Bore Field Grouting



The 'Bore Field Grouting' slide contains four small photographs. The top-left photo shows a grouting rig. The top-right photo shows a worker. The bottom-left photo shows a grouting rig. The bottom-right photo shows a worker. The logo 'G' is visible in the bottom right corner.

Bore Field Header

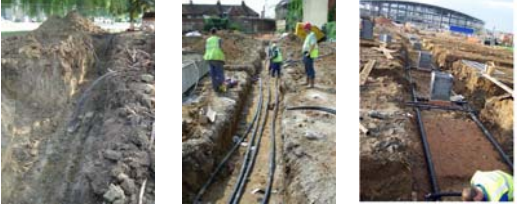

The 'Bore Field Header' slide contains three small photographs. The left photo shows a worker. The middle photo shows workers. The right photo shows workers. The logo 'G' is visible in the bottom right corner.

Testing



System Design

- Ground Source Heat Pumps
 - Recognised ground loop design
 - Maintain minimum ground side and building side flow rates
- LTHW & CHW
 - Emitters appropriately sized
 - Pipe appropriately sized
- DHW
 - Preheat to DHW
 - Legionella control

